

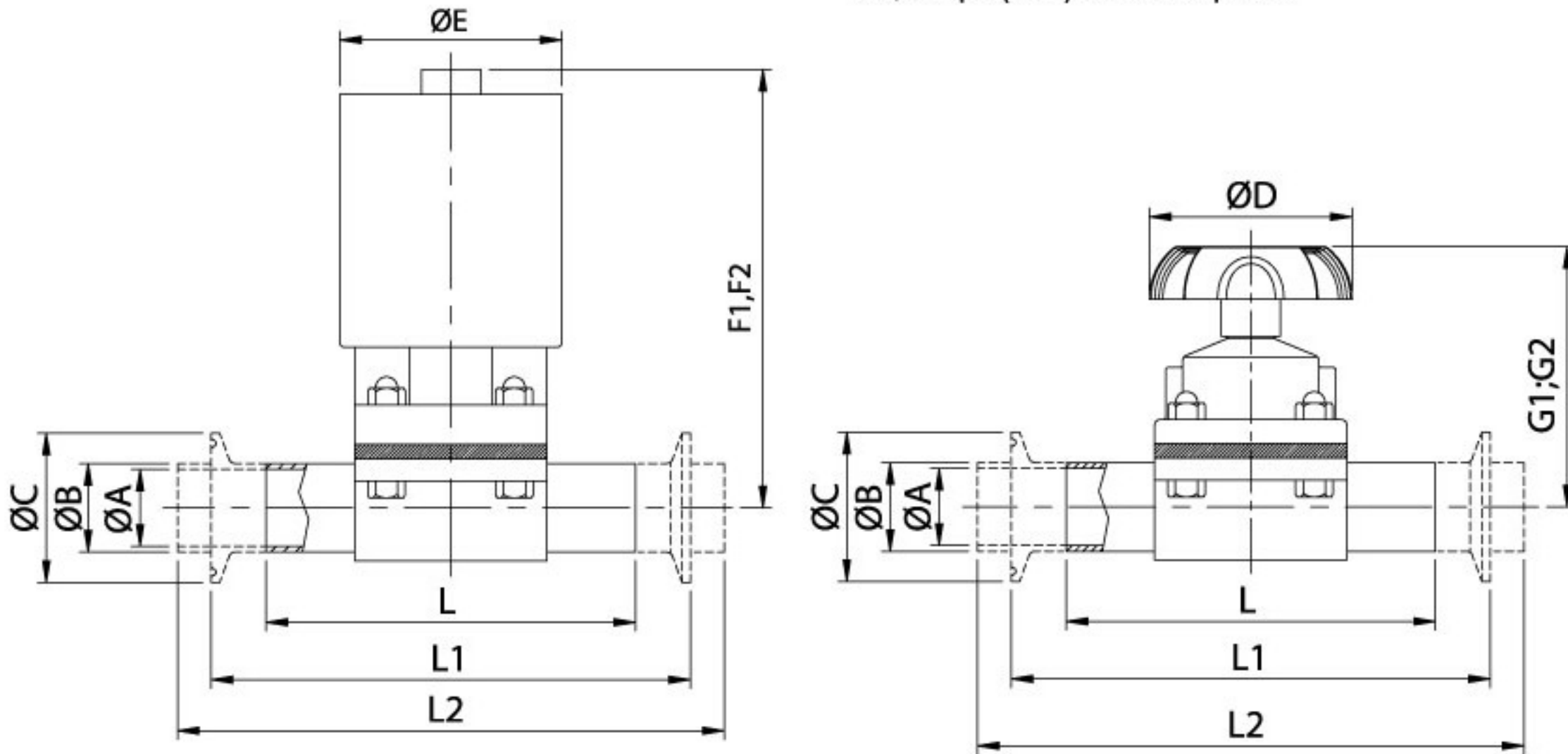

Pneumatic/Manual Diaphragm Valve 2WAY/Tank Bottom Valve



CSE Pneumatic diaphragm valve Aspect design can be widely applied to the fields, such as pharmacy, beer, food, beverage, fluid equipment, cosmetic and so on.
 Control mode: Manual Type & Pneumatic Type
 Connection type: Clamp or Weld or other ...
 Operation: Normal Open & Normal Close design
 Body Material: 316L, Forged Or Casting .
 Connection: INCH: 1/2"~2", DIN / ISO: DN10-DN50 other size can be requirement
 Working temp: Assembling Diaphragm: EPDM(-40°C ~110°C, PTFE / EPDM(-10°C~150°C)
 Working pressure: Max 10 Bar
 Surface: Standard: OD / ID mirror polished. ID Ra< 0.5µm.
 OD- Sand Blasted or E/P or others, ID – Polishing to Ra<0.5µm(SF1) or E/P Finished Ra,0.38µm(SF4) can be required.



SIZE	ØA	ØB	ØC	L	L1	L2	F1	F2	G1	G2	ØD	ØE
1/2"	9.4	12.7	60	77	94.4	129	122	131	74	83	60	60
3/4"	15.75	19.05	60	77	94.4	129	122	131	74	83	60	60
1.0"	22.1	25.4	95	100	125	145	212	225	100	113	95	85
1.5"	34.8	38.1	95	133	159	169	217	232	119	134	95	85
2.0"	47.5	50.8	118	166.5	192	191	315	333	135	153	118	133

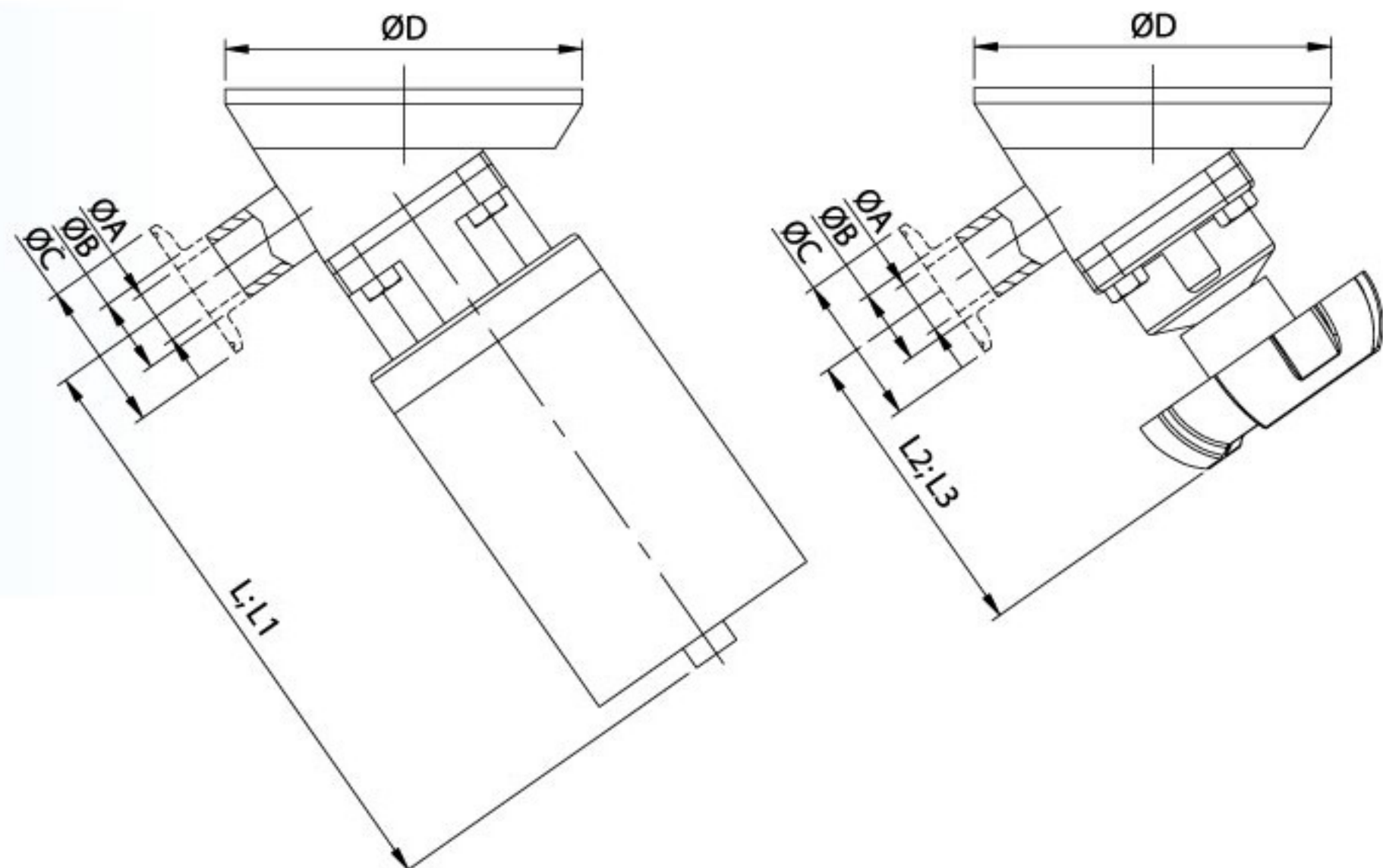

SIZE	ØA	ØB	ØC	ØD	L(close)	L1(open)	L2(close)	L3(open)
1.0"	22.1	25.4	50.5	120	212	225	100	113
1.5"	34.8	38.1	50.5	160	217	232	119	134
2.0"	47.5	50.8	64	160	315	333	135	153