

Performance Specifications Table

Nominal pressure Class	6000PSI	
Body testing	62.1	MPa
Seal testing	45.5	
Operating temperature		
Applicable media: water, Steam, Oil, Power Station		

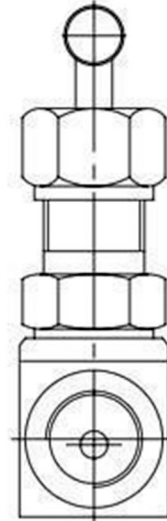
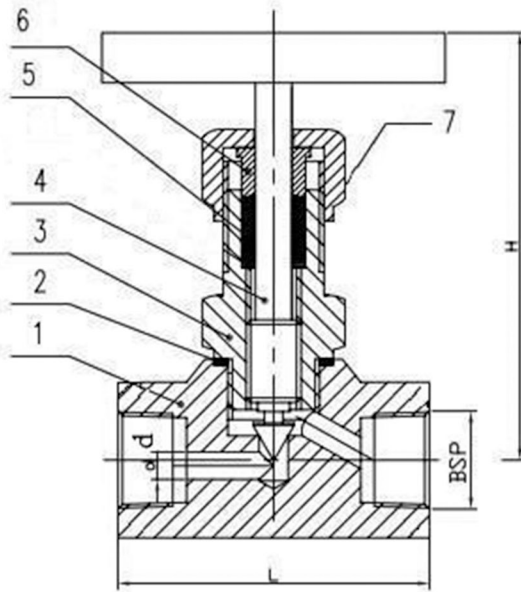

NOTES:  
 1.THREADED END:BS21-1957  
 2.DESIGNED BY:ASME B16.34;  
 3.TESTED AND CHECKED BY:API 598;  
 4.FACE TO FACE END:DIN3202 M4-1994.

7	GLAND NUT	A182 F316
6	GLAND	A182 F316
5	PACKING GLAND	PTFE
4	PACKING GASKET	A182 F316
3	CAP	A182 F316
2	GASKET	GRAPHITE
1	BODY	A182 F316
<b>NO</b>	<b>PART NAME</b>	<b>MATERIAL</b>

DIMENSION LIST

NPS	d	L
1/4"	5	54
3/8"	5	56
1/2"	6	63
3/4"	7	70
1"	10	90
1-1/4"	13	93
1-1/2"	18	103
2"	22	131

**ST400 BSP S/316**