



Szalai és Társa Kft.
1992

F16/40F1-304/316



Y-STRAINERS



APPLICATION :

Chemical and pharmaceutical, petrochemical industries, pressurized air, industry, etc.

GENERAL CHARACTERISTICS :

Removable stainless steel filter.
PN-16 Flanges RF.
Horizontal or Vertical position
Position indicator arrow.
Mesh 8/10" mm (800 μ) up to DN50, 10/10" mm from DN65 to 80 and 30/10" over.
Bolted bonnet
Draining cap threaded BSP.

STANDARDS :

Manufacture according to ISO 9001 : 2008.
Directive 2014/68/EU
Construction according to EN 12516-1 9001 : 2008.
Pressure Tests according to API 598 , table 6.
NP-16 Flanges RF according to EN 1092-1.
Length according to EN 558 series 1 (DIN 3202 F1 - NF 29354).
Certificate atex Category 2 G/2D Zone 1 & 21 Zone 2 & 22 (optional marking).

WORKING CONDITIONS :

Maximum Working Pressure : 16 bar.
Maximum allowed fluid Temperature : -20 °C / +200 °C.

MATERIALS:

No.	Part	Material
1	Body	S Steel CF8/CF8M
2	Filter	S Steel 304
3	Bonnet	S Steel 316
4	Draining cap	S Steel 316
5	Gasket	PTFE
6	Body gasket	RPTFE
7	Washer	S Steel 304
8	Bolt	S Steel 304

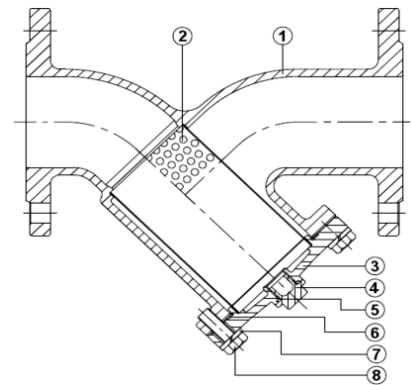
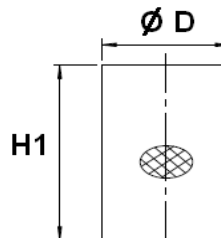

DIMENSIONS :

DN	L	H	G (drain)	ØD	H1	Mesh	Weight
15	130	85	1/2"	19	57	0,8	2
20	150	85	1/2"	24	55	0,8	2,7
25	160	112	1/2"	27	87	0,8	3,5
32	180	114	1/2"	40	82	0,8	5
40	200	132	1/2"	43	99,5	0,8	6,1
50	230	150	1/2"	54	102	0,8	8,1
65	290	185	1/2"	65	135	1	12,3
80	310	200	1/2"	85	150	1	15,5
100	350	232	3/4"	103	160	3	22
125	400	274	3/4"	128	221	3	30
150	480	328	3/4"	154	250	3	45,1
200	600	410	3/4"	208	300	3	77,1

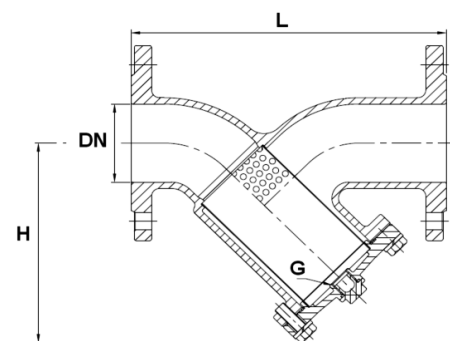

FLOW COEFFICIENT:

Size	15	20	25	32	40	50	65	80	100	125	150	200
Kvs (m3/h)	2,59	6,05	12,1	17,3	27,7	56,2	85,5	138,4	259,5	415,1	605,4	882,3

fax: (1) 260 2607
tel: (1) 433 3914

warehouse: 2360 Gyál, Bánki Donát utca 28.
office: 1108 Budapest, Venyige utca 3.

e-mail: szalaikft@szalaikft.hu
web: www.szalaikft.hu