



Szalai és Társa Kft.
1992

TZ800-SW/NPT-A105



GATE VALVES



APPLICATION :

Nafta, steam, petrochemical, petroleum, high pressure.

GENERAL CHARACTERISTICS :

Range: 3/8" - 2"

Rising rotating stem OS&Y

Bolted bonnet.

Stellite Metal-metal seat F6+XU TRIM 8.

Respect the flow direction indicated by the arrow.

Standar Port.

class 800 lbs.

STANDARDS :

Manufacture according to ISO 9001 : 2008.

Directive 2014/68/EU

Pressure Tests according to API 598 Table 6.

BSP Conical according to ISO 7-1 Rc.

NPT according to ANSI B1.20.1.

Directive 2014/34/EU.

WORKING CONDITIONS :

Maximum Working Pressure : 136 bar.

Maximum Working Temperature : -29 °C / +425 °C.

MATERIALS:

No.	Part	Material
1	Wheel nut	Carbon steel
2	Name plate	Aluminium
3	Handwheel	Carbon steel
4	Yoke nut	ASTM A582 type 416
5	Gland nut	ASTM A194 Gr. 2H
6	Gland flange	ASTM A105
7	Gland stud	SS410
8	Gland	ASTM A276 type 410
9	Packing	Graphite
10	Bolts	ASTM A193 Gr. B7
11	Stem	ASTM A276 type 410
12	Bonnet	ASTM A105
13	Gasket	SS316 + Graphite
14	Seat	Stellite Gr. 6
15	Wedge	ASTM A186 F6
16	Body	ASTM A105

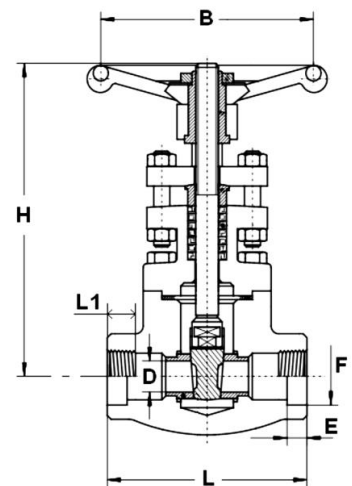
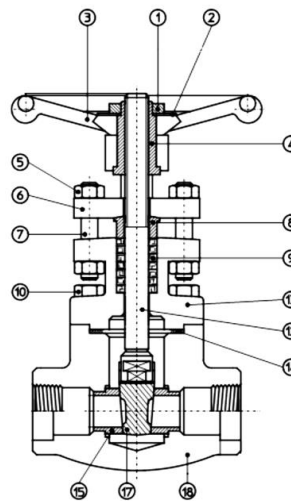

DIMENSIONS :

DN	ØD	L	H (open)	ØB	L1	E(SW)	ØF(SW)	Kvs m3/h	Weight
3/8"	9,6	80	148	90	13	11,1	17,6	3,7	1,84
1/2"	9,6	80	148	90	15	12,7	21,8	4,8	1,84
3/4"	14	90	163	90	18	14,5	27,2	10,4	2,06
1"	18	110	178	110	19	16	33,9	23,4	3,35
1 1/4"	24	127	210	110	20	17,5	42,7	47,6	4,9
1 1/2"	30	127	243	130	21	19	48,8	69,2	6,5
2"	36,5	127	262	180	21	22	61,2	90,8	8,8

fax: (1) 260 2607
tel: (1) 433 3914

warehouse: 2360 Gyál, Bánki Donát utca 28.
office: 1108 Budapest, Venyige utca 3.

e-mail: szalaikft@szalaikft.hu
web: www.szalaikft.hu