



Szalai és Társa Kft.  
1992

# P1W16/10-S-EPDM-GEAR



**APPLICATION :** Corrosive fluids.

**GENERAL CHARACTERISTICS :**

Concentric Disc Valves .  
Range from DN40 up to DN800 .  
Tightness in both ways.  
Long neck for heat-insulated installations.  
One-piece shaft. Avoid breakage due to water hammer.  
Cartridge Seat for easy replacement.  
Reduced dimensions and weights  
Does not need joints for installation.  
Low head loss.  
Top Flange according to ISO 5211.  
Gearbox.

**STANDARDS :**

Design : BS EN 593.  
Face to Face : EN 558-1 Serie 20, ISO 5272 Serie 20, DIN 3202.  
Mounting between flanges : PN10  
Pressure Test : EN 12266-1, DIN 3230, BS6755 y ISO 5208:  
Body : 15 bar. Seat : 11 bar.  
Directive 2014/68/EU

**MATERIALS:**

No.	Part	Material
1	Body	DI
2	Seat	EPDM
3	Bottom Shaft	SS420
4	Disc	CF8M
5	Upper Shaft	SS420
6	Worm gear	DI

**WORKING CONDITIONS :**

Maximum Working Pressure : 10 bar.  
Maximum Working Temperature : -10 °C / +120 °C.

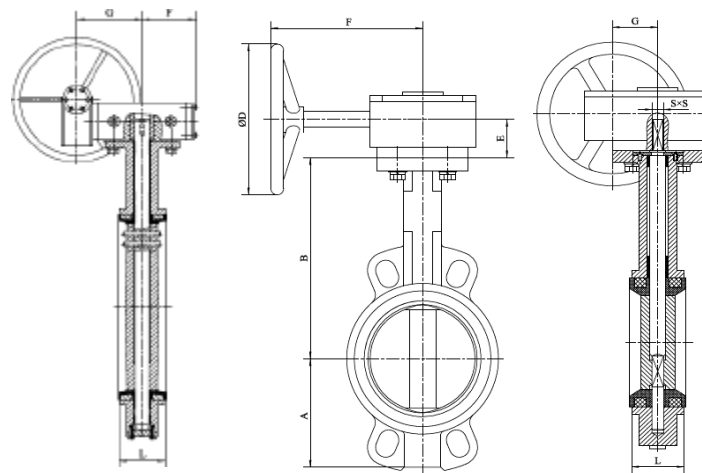

**DIMENSIONS :**

DN	A	B	D	SxS	E	F	G	L	Torque	ISO 5211	Weight
40	70	145	138	9x9	27	144	48	33	12	F05	5,9
50	72	129	138	9x9	27	144	48	42	19	F05	6
65	75	136	138	9x9	27	144	48	45	25	F05	7
80	97	144	138	9x9	27	144	48	45	30	F05	7,5
100	108	162	138	11x11	27	144	48	52	45	F07	9
125	123	188	138	14x14	27	144	48	54	60	F07	10,5
150	142	204	138	14x14	27	144	48	56	95	F07	12,5
200	169	238	278	17x17	39	208	66	60	200	F07	20,5
250	201,5	282	278	22x22	39	208	66	66	250	F10	26,5
300	241,5	311	278	22x22	37	225	80	77	400	F10	40
350	277	368	300	22x22	42	226	81	77	675	F12	46

fax: (1) 260 2607  
tel: (1) 433 3914

warehouse: 2360 Gyál, Bánki Donát utca 28.  
office: 1108 Budapest, Venyige utca 3.

e-mail: [szalaikft@szalaikft.hu](mailto:szalaikft@szalaikft.hu)  
web: [www.szalaikft.hu](http://www.szalaikft.hu)