



Szalai és Társa Kft.
1992

P1L16/10-S-PTFE-K-GSC



BUTTERFLY VALVE



STANDARD MATERIALS:

No.	Part	Material
1	Body	WBC
2	Stem	17-4PH
3	Liner	PTFE
4	Disc	CF8M
5	O Ring	VITON

APPLICATION :

LUG, HVAC installations, pressurized air, industry, etc.

GENERAL CHARACTERISTICS :

Concentric Disc Valves.
Range from ND40 up to ND300 .
Tightness in both ways.
Threaded ears.
One-piece shaft. Avoid breakage due to water hammer.
Cartridge Seat for easy replacement.
Reduced dimensions and weights.
Does not need joints for installation.
Low load loss.
Top Flange according to ISO 5211.
10 position lever.

STANDARDS :

Design : BS EN 593.
Face to Face : EN 558-1 Serie 20, ISO 5272 Serie 20, DIN 3202.
Mounting between flanges : PN10 / PN16 EN 1092-2
Pressure Test : EN 12266-1, DIN 3230, BS6755 and ISO 5208:
Body : 15 bar. Seat : 11 bar.
Directive 2014/68/EU

WORKING CONDITIONS :

Maximum Working Pressure : 10 bar.
Maximum Working Temperature : -20 °C / +180 °C.

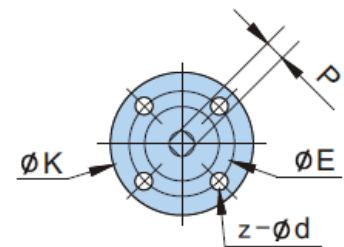
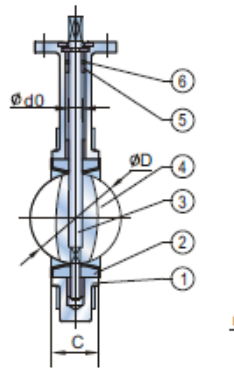
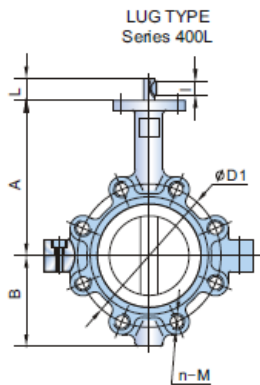

DIAGONAL SQUARE HEAD

SIZE												UPPER FLANGE			DIN PN10/16			Weight (kg)
in	DN	A	B	C	D	L	d0	P	H	K	E	z-d	D1	n-d1	M	Lug		
1-1/2	40	145	75	33	42.4	32	12.6	9	10	77	50	4-7	110	4-18	M16	4.2		
2	50	160	80	42	52.6	32	14.3	11	10	90	70	4-9	125	4-18	M16	4.75		
2-1/2	65	175	89	44.7	64.5	32	14.3	11	10	90	70	4-9	145	4-18	M16	5.95		
3	80	181	95	45.2	78.8	32	14.3	11	10	90	70	4-9	160	4/8-18	M16	6.20		
4	100	200	114	52.1	104	32	15.77	11	12	90	70	4-9	180	8-18	M16	9.95		
5	125	213	127	54.4	123.3	32	18.92	14	14	90	70	4-9	210	8-18	M16	12.13		
6	150	226	139	55.8	155.6	32	18.92	14	14	90	70	4-9	240	8-23	M20	14.44		
8	200	260	175	60.6	202.5	45	22.1	17	17	125	102	4-12	295	8/12-23	M20	23		
10	250	292	203	65.6	250.5	45	28.45	22	22	125	102	4-12	350/355	12-23/27	M20/M24	33.70		
12	300	337	242	76.9	301.6	45	31.6	22	24	140	102	4-12	400/410	12-23/27	M20/M24	50.11		

fax: (1) 260 2607
tel: (1) 433 3914

warehouse: 2360 Gyál, Bánki Donát utca 28.
office: 1108 Budapest, Venyige utca 3.

e-mail: szalaikft@szalaikft.hu
web: www.szalaikft.hu