

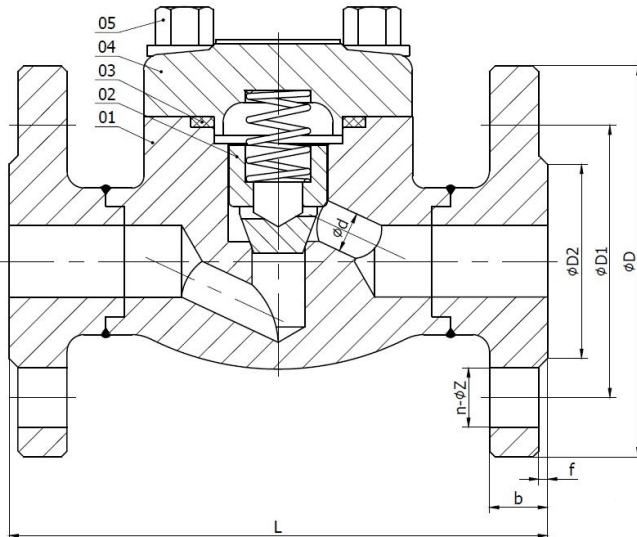

Szalai és Társa Kft.
1992

RD100F2-A105

CHECK VALVES



05	Blot	B7
04	Bonnet	A105
03	Gasket	304+Graphite
02	Disc	F6a
01	Body	A105+13Cr
NO.	Part Name	Material

Specification standard sheet	
Shell test	15.0
High-pressure seal test	11.0
Back seal test	--
Low-pressure seal test	0.6
Applicable temperature	-29~425 °C
Applicable medium:	water, steam, oil, etc
Design and manufacture	DIN 3356
Face to face	DIN 3202-F2
End flange	DIN 2526
Inspection and test	DIN 3230
CHECK VALVE	PN100RF

DN	L	D	D1	D2	b	n- φZ	f
15	210	φ 105	φ 75	φ 45	20	4- φ 14	2
20	230	φ 130	φ 90	φ 58	22	4- φ 18	2
25	230	φ 140	φ 100	φ 68	24	4- φ 18	2
32	260	φ 155	φ 110	φ 78	26	4- φ 22	2